

WIDE
INNOVATIONS[®]
PIPELINE SOLUTIONS

CONEXIONES MECÁNICAS **SERIE 7**



PLASSON[®]

Compression Fittings

0701M0

Page 8

Coupling
Enlace Recto



0761M0

Page 8

Repair Coupling
Enlace recto de reparación



0711M0

Page 9

Reducing Coupling
Enlace Recto Reductor



0702M0

Page 9

Male Adaptor
Enlace Mixto Rosca Macho



0702M0T

Page 10

Male Adaptor
Enlace Mixto Rosca Macho



0703M0

Page 10

Female Adaptor
Enlace Mixto Rosca Hembra



0703M0T

Page 11

Female Adaptor
Enlace Mixto Rosca Hembra



0712M0

Page 11

End Plug
Tapón Final



0704M0

Page 12

90° Tee
Te de 90°



0784M0

Page 12

90° Tee with Threaded
Male Offtake
Te de 90° Compresión
Rosca Macho



0714M0

Page 12

90° Tee with Threaded
Female Offtake
Te de 90° Compresión
Rosca Hembra



0734M0

Page 13

90° Reducing Tee
Te de 90° Reductor



0764M0

Page 13

45° Tee
Te de 45°



0774M0

Page 14

90° Enlarging Tee
Te de Alargado



0705M0

Page 14

90° Elbow
Codo de 90°



0751M0

Page 14

90° Reducing Elbow
Codo de 90°



0706M0

Page 15

45° Elbow
Codo de 45°



0785M0

Page 15

90° Elbow with Threaded
Male Offtake
Codo de 90° Compresión
Rosca Macho



0715M0

Page 16

90° Elbow with Threaded
Female Offtake
Codo de 90° Compresión
Rosca Hembra



0775M0

Page 16

Wall Plate Elbow
Codo de Aplicación Mural



070570M0

Page 16

Plas4 90° (Universal) Elbow
Plas4 - Codo de 90°
(universal)



07550

Page 17

Y-Fitting with Threaded
Male Offtake
Y compresión rosca macho



070170M0

Page 17 | Plass4 (Universal) Coupling
Plass4 Enlace (universal)



0701MZ0

Page 17 | Imperial to CTS Coupler
Adaptor
Enlace Adaptor Recto
Imperial - CTS



0793M

Page 18 | Reducing Set
Juego reductor



Valves

03703T

Page 19 | Ball Valve
Válvula esférica



0340M0

Page 19 | Compression Stoptap
(seal NBR)
Válvula de Línea Compresión
(juntas NBR)



03405

Page 20 | Threaded Stoptap
(seal NBR)
Válvula de Línea Rosca
Hembra (juntas NBR)



03068

Page 20 | Check Valve (seal EPDM)
Threaded Inlet & Outlet
Válvula Antirretorno
(selo EPDM) Roscas Macho



0220

Page 20 | Universal Pressure Regulator
UPR 550
Regulador Universal de
Presión UPR 550



03801

Page 21 | Fix Ratio Pressure
Reducing Valve
Válvula Reductora
de Presión FIX RATIO



03047

Page 21 | Angle Seat Valve (seal NBR)
Threaded Inlet & Outlet
Válvula de Asiento Angular
(selo NBR) Roscas Macho



03049

Page 21 | Angle Seat Valve (Seal FPM)
Threaded Inlet & Outlet
Válvula de Asiento Angular
Roscas Macho



03039

Page 22 | Quick Coupling Valve (SEAL NBR)
Válvula de Acople Rápido
(juntas NBR)



03139

Page 22 | Key for Quick Coupling
Valve 3039
Conexión de Acople Rápido



Conversion & Adaptor sets

17610

Page 22 | Universal Slip Repair
Coupler



07990

Page 23 | Plasson Wrench
Llave Plasson



0701M

Page 23 | Adaptor Coupling - IPSX mm



07003Q

Page 23 | Split Ring for UPVC
and PP pipes



07002MV

Page 24 | O Ring Viton



0797M

Page 24 | Stainless steel adaptor disc
for PVC



Accessories for Compression Fittings

0701Q6

Page 25 | Grip Ring for UPVC and PP Pipe
Casquillo de apriete para tubos
de UPVC y PP



07960

Page 25 | Chamfer Tool for PE Pipes
Herramienta para biselar



Coupling

0701M0

Enlace recto

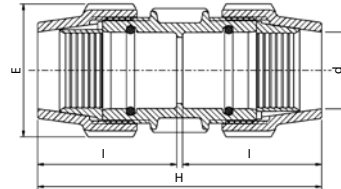

Product Code	Size d x d	E	H	I	UB	UC	W
0701M0005	½" x ½"	1.89	4.76	2.28	10	200	0.20
0701M0007	¾" x ¾"	2.13	4.92	2.36	10	180	0.26
0701M0010	1" x 1"	2.52	5.71	2.76	5	100	0.42
0701M0013	1¼" x 1¼"	3.23	6.97	3.39	—	75	0.72
0701M0015	1½" x 1½"	3.78	7.91	3.86	—	45	1.05
0701M0020	2" x 2"	4.45	9.06	4.41	—	30	1.60
0701M0030	3" x 3"	5.98	13.35	6.30	—	10	4.32
0701M0040	4" x 4"	7.12	15.74	7.68	—	5	6.34

Repair Coupling

0761M0

Enlace recto de reparación

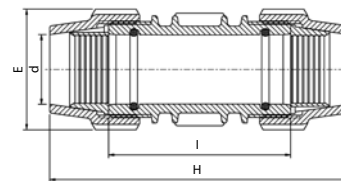

Product Code	Size d x d	E	H	I	UB	UC	W
0761M0007	¾" x ¾"	2.13	5.35	2.36	10	150	0.26
0761M0010	1" x 1"	2.52	6.85	2.76	5	80	0.44
0761M0013	1¼" x 1¼"	3.23	8.46	3.39	—	55	0.79
0761M0015	1½" x 1½"	3.78	9.60	3.86	—	30	1.17
0761M0020	2" x 2"	4.45	10.62	4.41	—	24	1.82
0761M0030	3" x 3"	5.98	13.89	6.3	—	10	4.15
0761M0040	4" x 4"	7.12	15.47	7.68	—	5	6.82

Reducing Coupling

0711M0

Enlace recto reductor

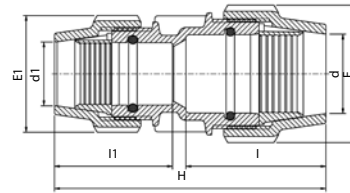

Product Code	Size d x d1	E	E1	H	I	I1	UB	UC	W
0711M0007005	¾" x ½"	2.13	1.89	4.69	1.89	4.69	10	200	0.23
0711M0010005	1" x ½"	2.52	1.89	5.31	1.89	5.31	5	150	0.31
0711M0010007	1" x ¾"	2.52	2.13	5.16	2.13	5.16	5	120	0.34
0711M0013007	1¼" x ¾"	3.23	2.13	6.10	2.13	6.10	—	90	0.51
0711M0013010	1¼" x 1"	3.23	2.52	6.10	2.52	6.10	—	90	0.56
0711M0015007	1½" x ¾"	3.78	2.13	6.93	2.13	6.93	—	70	0.66
0711M0015010	1½" x 1"	3.78	2.52	6.81	2.52	6.81	—	70	0.75
0711M0015013	1½" x 1¼"	3.78	3.23	7.17	3.23	7.17	—	60	0.88
0711M0020007	2" x ¾"	4.45	2.13	7.36	2.13	7.36	—	50	1.02
0711M0020010	2" x 1"	4.45	2.52	7.83	2.52	7.83	—	45	1.07
0711M0020013	2" x 1¼"	4.45	3.23	8.23	3.23	8.23	—	40	1.20
0711M0020015	2" x 1½"	4.45	3.78	8.46	3.78	8.46	—	36	1.29
0711M00400030	3" x 2"	5.98	4.45	11.10	5.98	4.33	—	14	3.18
07110040030	4" x 3"	7.13	5.98	14.84	7.68	6.38	—	6	5.61

Male Adaptor

0702M0

Enlace mixto rosca macho

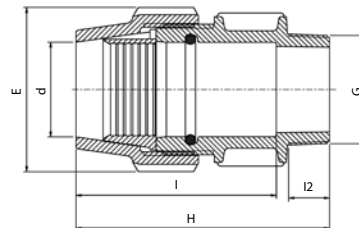

Product Code	Size d x G	E	H	I	I2	UB	UC	W
0702M0005005	½" x ½"M	1.89	3.58	2.76	0.67	10	350	0.13
0702M0005007	½" x ¾"M	1.89	3.62	2.76	0.71	10	350	0.14
0702M0007005	¾" x ½"M	2.13	3.74	2.83	0.67	10	250	0.15
0702M0007007	¾" x ¾"M	2.13	3.74	2.83	0.71	10	250	0.17
0702M0010007	1" x ¾"M	2.52	4.09	3.23	0.71	5	150	0.24

Male Adaptor

0702M0T

Enlace mixto rosca macho

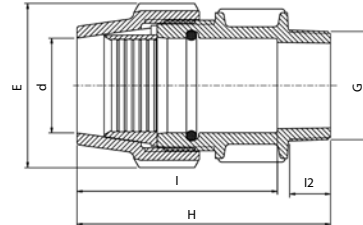

Product Code	Size d x G	E	H	I	I2	UB	UC	W
0702M0T10010	1" x 1"M	2.52	4.17	3.23	0.79	5	150	0.27
0702M0T13010	1¼" x 1"M	3.23	4.49	3.39	0.79	—	110	0.42
0702M0T13013	1¼" x 1¼"M	3.23	4.57	3.46	0.87	—	110	0.42
0702M0T13015	1¼" x 1½"M	3.23	4.69	3.58	0.87	—	100	0.44
0702M0T15013	1½" x 1¼"M	3.78	5.20	4.45	0.87	—	70	0.58
0702M0T15015	1½" x 1½"M	3.78	5.31	4.21	0.87	—	70	0.61
0702M0T15020	1½" x 2"M	3.78	5.47	4.21	1.02	—	65	0.62
0702M0T20015	2" x 1½"M	4.45	5.98	4.88	0.87	—	48	1.04
0702M0T20020	2" x 2"M	4.45	6.57	5.28	1.02	—	48	1.02

Female Adaptor

0703M0

Enlace mixto rosca hembra

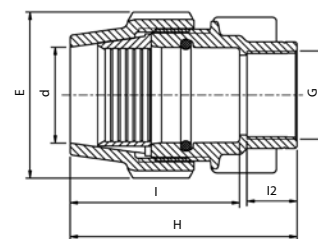

Product Code	Size d x G	E	H	I	I2	UB	UC	W
0703M0005005	½" x ½"F	1.89	3.23	2.32	0.75	10	350	0.13
0703M0005007	½" x ¾"F	1.89	3.23	2.32	0.75	10	350	0.13
0703M0007007	¾" x ¾"F	2.13	3.50	2.52	0.83	10	250	0.18
0703M0010007	1" x ¾"F	2.52	3.35	2.48	0.75	5	150	0.24

Female Adaptor

0703M0T

Enlace mixto rosca hembra

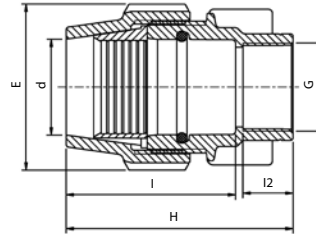

Product Code	Size d x G	E	H	I	I2	UB	UC	W
0703M0T10010	1" x 1"F	2.52	3.66	2.64	0.83	5	150	0.25
0703M0T13010	1¼" x 1"F	3.23	4.29	3.27	0.83	—	110	0.39
0703M0T13013	1¼" x 1¼"F	3.23	4.21	3.03	0.98	—	110	0.45
0703M0T13015	1¼" x 1½"F	3.23	4.53	3.35	0.98	—	100	0.50
0703M0T15013	1½" x 1¼"F	3.78	4.72	3.50	0.98	—	75	0.61
0703M0T15015	1½" x 1½"F	3.78	4.96	3.66	0.98	—	70	0.63
0703M0T15020	1½" x 2"F	3.78	5.08	3.70	1.18	—	70	0.65
0703M0T20020	2" x 2"F	4.45	5.71	4.69	1.18	—	48	0.95

End Plug

0712M0

Tapón final

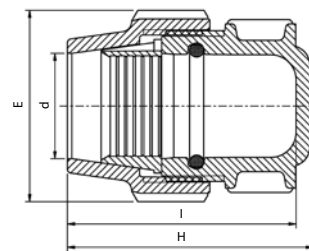

Product Code	Size d	E	I	H	UB	UC	W
0712M0005	½"	1.89	2.91	3.11	10	350	0.07
0712M0007	¾"	2.13	2.99	3.23	10	250	0.17
0712M0010	1"	2.52	3.19	3.43	5	180	0.231
0712M0013	1¼"	3.23	3.46	3.86	—	110	0.405
0712M0015	1½"	3.78	4.29	4.57	—	75	0.59
0712M0020	2"	4.45	5.24	5.51	—	45	0.90
0712M0030	3"	5.98	7.80	8.42	—	16	2.44
0712M0040	4"	7.13	8.46	9.33	—	10	3.76

90° Tee

0704M0

Te de 90°

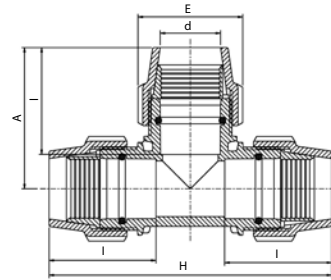

Product Code	Size d	E	H	I	A	UB	UC	W
0704M0005	1/2" x 1/2" x 1/2"	1.89	5.71	2.24	2.91	10	120	0.33
0704M0007	3/4" x 3/4" x 3/4"	2.13	5.98	2.24	3.03	5	100	0.42
0704M0010	1" x 1" x 1"	2.52	6.89	2.56	3.46	5	60	0.66
0704M0013	1 1/4" x 1 1/4" x 1 1/4"	3.23	8.70	3.39	4.37	—	40	1.14
0704M0015	1 1/2" x 1 1/2" x 1 1/2"	3.78	9.92	3.74	4.96	—	25	1.65
0704M0020	2" x 2" x 2"	4.45	11.50	4.29	5.75	—	16	2.52
0704M0030	3" x 3" x 3"	5.98	17.16	6.42	8.58	—	5	7.16
0704M0040	4" x 4" x 4"	7.13	23.15	7.72	11.57	—	2	11.47

90° Tee with Threaded Male Offtake

0784M0

Te de 90° compresión rosca macho

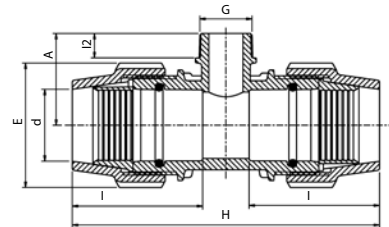

Product Code	Size d x G x d	E	H	I	I2	A	UB	UC	W
0784M0005005	1/2" x 1/2" M x 1/2"	1.89	5.43	2.28	0.63	1.81	10	180	0.23
0784M0007007	3/4" x 3/4" M x 3/4"	2.13	5.91	2.40	0.71	1.97	5	140	0.30

90° Tee with Threaded Female Offtake

0714M0

Te de 90° compresión rosca hembra

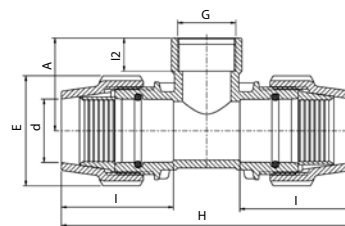

Product Code	Size d x G x d	E	H	I	I2	A	UB	UC	W
0714M0005005	1/2" x 1/2" F x 1/2"	1.89	5.67	2.24	0.75	1.65	10	180	0.25
0714M0007007	3/4" x 3/4" F x 3/4"	2.13	5.91	2.28	0.75	1.89	5	140	0.31

90° Reducing Tee

0734M0

Te de 90° reductor

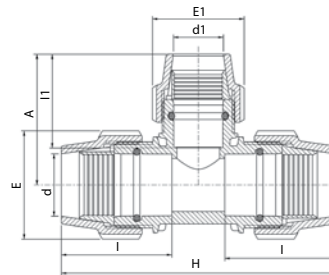

Product Code	Size d x d1 x d	E	E1	H	I	I1	A	UB	UC	W
0734M0007005	¾" x ½" x ¾"	2.09	1.89	6.06	2.36	2.28	2.99	5	100	0.39
0734M0010007	1" x ¾" x 1"	2.48	2.09	6.73	2.60	2.36	3.35	5	70	0.59
0734M0013007	1¼" x ¾" x 1¼"	3.23	2.09	7.95	3.23	2.36	3.35	—	45	0.89
0734M0013010	1¼" x 1" x 1¼"	3.23	2.48	8.23	3.23	2.60	3.78	—	40	0.97
0734M0015007	1½" x ¾" x 1½"	3.78	2.09	8.74	3.66	3.07	4.21	—	30	1.29
0734M0015010	1½" x 1" x 1½"	3.78	2.48	8.74	3.66	2.60	4.57	—	30	1.35
0734M0015013	1½" x 1¼" x 1½"	3.78	3.23	9.29	3.66	3.23	4.49	—	30	1.45
0734M0020010	2" x 1" x 2"	4.45	2.48	10.47	4.41	2.60	4.57	—	20	1.97
0734M0020013	2" x 1¼" x 2"	4.45	3.23	10.47	4.41	3.31	5.47	—	20	2.08
0734M0020015	2" x 1½" x 2"	4.45	3.78	10.75	4.29	3.66	5.31	—	18	2.22

45° Tee

0764M0

Te de 45°

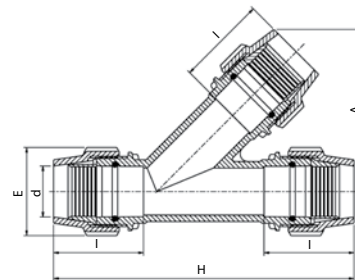

Product Code	Size d x d x d	E	H	I	A	UB	UC	W
0764M0020	2" x 2" x 2"	4.45	14.68	4.33	8.15	—	10	3.06
0764M0030	3" x 3" x 3"	5.98	20.24	6.38	9.17	—	4	8.15
0764M0040	4" x 4" x 4"	7.13	24.61	7.64	11.18	—	2	13.00

90° Enlarging Tee

0774M0

Te de alargado

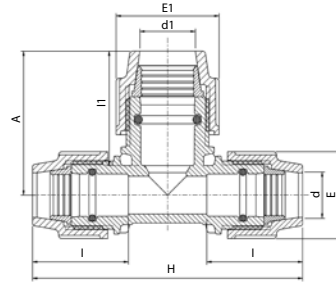

Product Code	Size d x d1 x d	E	E1	H	I	I1	A	UB	UC	W
0774M0007010	¾" x 1" x ¾"	2.13	2.52	5.98	2.32	2.56	3.58	5	80	—

90° Elbow

0705M0

Codo de 90°

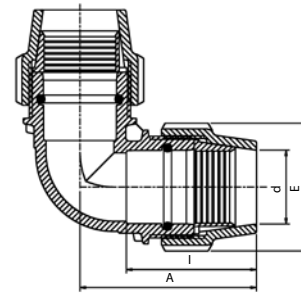

Product Code	Size d x d	E	I	A	UB	UC	W
0705M0005	½" x ½"	1.89	2.13	2.87	10	200	0.22
0705M0007	¾" x ¾"	2.13	2.24	2.99	10	150	0.28
0705M0010	1" x 1"	2.52	2.60	3.62	5	100	0.45
0705M0013	1¼" x 1¼"	3.23	3.27	4.29	—	60	0.78
0705M0015	1½" x 1½"	3.78	3.66	4.84	—	35	1.13
0705M0020	2" x 2"	4.45	4.33	5.94	—	24	1.75
0705M0030	3" x 3"	5.98	6.41	8.58	—	8	4.90
0705M0040	4" x 4"	7.13	7.72	11.57	—	4	7.84

90° Reducing Elbow

0751M0

Codo de 90° reductor

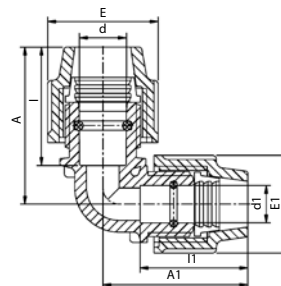

Product Code	Size d x d1	E	E1	I	I1	A	A1	UB	UC	W
0751M0007005	¾" x 1/2"	2.12	1.89	2.28	2.24	3.54	2.95	10	180	0.251

45° Elbow

0706M0

Codo de 45°

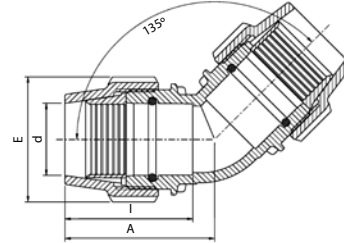

Product Code	Size d x d	E	I	A	UB	UC	W
0706M0010	1" x 1"	2.52	2.60	3.31	5	100	0.4
0706M0013	1¼" x 1¼"	3.23	3.27	3.86	—	60	0.73
0706M0015	1½" x 1½"	3.78	3.66	4.33	—	40	1.07
0706M0020	2" x 2"	4.45	4.33	5.12	—	24	1.66
0706M0030	3" x 3"	5.98	6.38	7.56	—	8	4.66
0706M0040	4" x 4"	7.13	7.64	9.25	—	5	6.97

90° Elbow with Threaded Male Offtake

0785M0

Codo de 90° compresión rosca macho

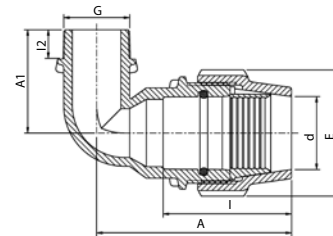

Product Code	Size d x G	E	I	I2	A	A1	UB	UC	W
0785M0005005	½" x ½"M	1.89	2.24	0.67	2.91	1.61	10	320	0.15
0785M0007005	¾" x ½"M	1.89	2.24	0.71	2.99	1.69	10	300	0.14
0785M0005007	½" x ¾"M	2.13	2.28	0.67	3.35	1.85	10	240	0.16
0785M0007007	¾" x ¾"M	2.13	2.28	0.71	3.50	1.89	10	250	0.18

90° Elbow with Threaded Female Offtake

0715M0

Codo de 90° compresión rosca hembra

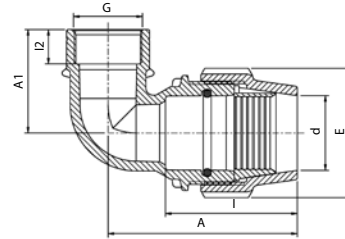

Product Code	Size d x G	E	I	I2	A	A1	UB	UC	W
0715M0005005	1/2" x 1/2"F	1.89	2.13	0.75	3.07	1.57	10	350	0.13
0715M0005007	1/2" x 3/4"F	1.89	2.05	0.75	2.83	1.73	10	300	0.16
0715M0007005	3/4" x 1/2"F	2.13	2.24	0.71	3.15	1.81	10	250	0.17
0715M0007007	3/4" x 3/4"F	2.13	2.24	0.75	3.15	1.81	10	250	0.19

Wall Plate Elbow

0775M0

Codo de aplicación mural

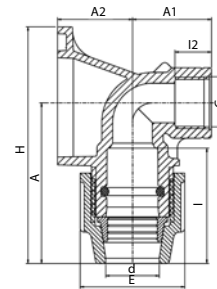

Product Code	Size d x G	E	I	I2	A	A1	A2	H	UB	UC	W
0775M0007007	1/2" x 1/2"F	1.89	2.28	0.71	3.11	1.57	1.50	4.45	1	150	0.20
0775M0005005	3/4" x 3/4"F	2.13	2.36	0.75	3.27	1.57	1.50	4.80	1	100	0.25

Plass4 90° (Universal) Elbow

070570M0

Plass4 - Codo de 90° (universal)

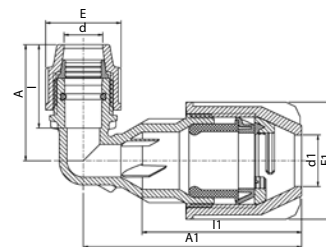

Product Code	Size d x d1	E	E1	I	I1	A	A1	UB	UC	W
070570M07022	3/4" x 0.59"-0.87"*	2.13	2.52	2.36	4.13	0.51	5.04	1	90	0.40
070570M07027	3/4" x 0.79"-1.06"*	2.13	2.80	2.36	4.13	3.27	5.47	1	80	0.49
070570M07035	3/4" x 1.06"-1.38"*	2.13	3.27	2.36	4.41	3.27	6.02	1	60	0.64

Y-Fitting with Threaded Male Offtake

0755M0

Y compresión rosca macho

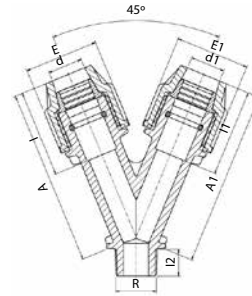

Product Code	Size d x d x R	E	E1	I	I1	I2	A	A1	UB	UC	W
0755M0007007	3/4" x 3/4" x 3/4" NPT	2.12	2.12	2.28	2.28	0.70	4.92	4.92	5	100	0.34

Plas4 (Universal) Coupling

070170M0

Plas4 Enlace (universal)

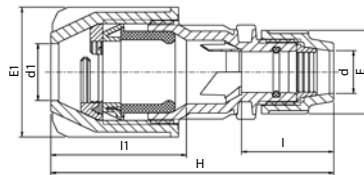

Product Code	Size d x d1	E	E1	I	I1	H	UB	UC	W
070170M07022	3/4" x 0.59"-0.87"	2.13	2.52	2.36	3.15	6.50	1	90	0.43
070170M07027	3/4" x 0.79"-1.06"	2.13	2.80	2.36	3.35	6.69	1	80	0.52
070170M07035	3/4" x 1.06"-1.38"	2.13	3.27	2.36	3.54	7.09	1	60	0.67
070170M10027	1" x 0.79"-1.06"	2.48	2.80	2.76	3.35	7.09	1	70	0.52
070170M10035	1" x 1.06"-1.38"	2.48	3.27	2.76	3.54	7.68	1	60	0.69
070170M15050	1 1/2" x 1.38"-1.97"	3.78	4.72	3.54	4.92	10.63	1	20	1.98

Coupling Adaptor PE to Copper

0701MZ0

Enlace adaptador PE-Cobre

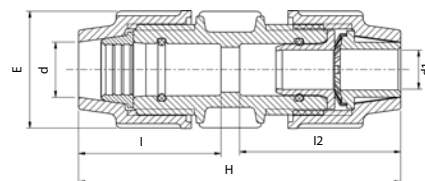

Product Code	Size d x d	E	E1	I	I1	H
0701MZ005005	1/2" x cts 1/2"	1.89	1.89	2.28	2.64	5.12
0701MZ007007	3/4" x cts 3/4"	2.13	2.13	2.36	2.72	5.20

Reducing Set

0793M

Juego reductor

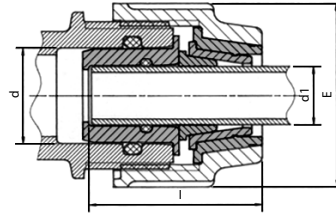

Product Code	Size d x d1	E	I	UB	UC	W
0793M0007005	3/4" x 1/2"	2.12	2.20	—	300	0.48

Ball Valve

03703T

Válvula esférica



Product Code	Size (female NPT)	Optional drain port*	H	H1**	E	I	B	A1	A2	UC	W
03703T0005	1/2"	1/8"	3.81		2.08	0.82	1.42	1.06	2.12	10	0.37
03703T0007	3/4"	1/8"	3.81		2.08	0.82	1.42	1.06	2.12	10	0.37
03703T0010	1"	1/8"	4.57		2.52	0.83	1.81	1.30	2.52	10	0.68
03703T0013	1 1/4"	1/4"	4.64		2.87	0.79	2.16	1.42	2.75	10	0.85
03703T0015**	1 1/2"	1/4"	5.66	180	3.58	0.94	2.56	1.77	3.42	10	1.56
03703T0020**	2"	1/4"	6.38	180	3.94	1.14	2.95	2.09	3.82	10	2.02

* With drain port: product code starts with 03703TF

** Equiped with long handle

Compression Stoptap (Seal NBR)

0340M0

Válvula de línea compresión (juntas NBR)

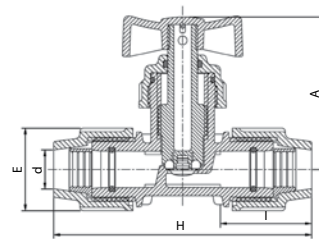

Product Code	Size d x d	E	H	I	A	UB	UC	W
0340M005	1/2" x 1/2"	1.89	5.79	2.28	3.98	5	100	0.35
0340M007	3/4" x 3/4"	2.13	6.18	2.36	3.58	5	80	0.42
0340M010	1" x 1"	2.52	6.42	2.76	3.74	5	60	0.55

Threaded Stoptap (Seal NBR)

03405

Válvula de línea rosca hembra (juntas NBR)

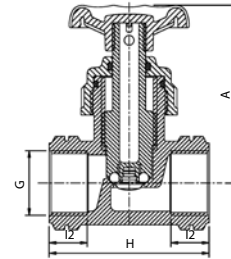

Product Code	Size G x G	H	I2	A	UB	UC	W
03405077	¾" x ¾"	3.07	0.71	3.62	5.00	140	0.25

Check Valve (Seal EPDM) Threaded Inlet & Outlet

03068

Válvula antirretorno, (sello EPDM) roscas macho

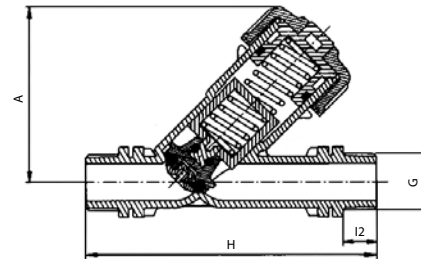

Product Code	Size G	H	I2	A	UB	UC	W
03068077	¾" x ¾"	5.94	0.71	3.78	5	140	0.31
03068110	1" x 1"	6.69	0.79	4.17	5	100	0.50
03068188	1¼" x 1¼"	7.87	0.87	5.28	—	55	0.84
03068155	1½" x 1½"	8.86	0.87	6.10	—	35	1.29
03068220	2" x 2"	10.00	1.02	7.17	—	20	2.15

Universal Pressure Regulator UPR 550

0220

Regulador Universal de Presión UPR 550

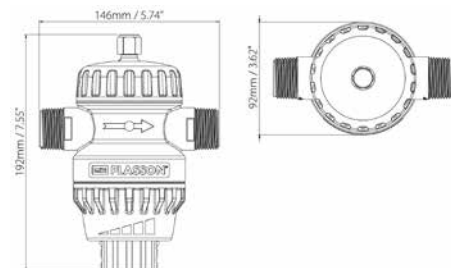

Product Code	Inlet/Outlet	Inlet Pressure	Outlet Pressure
02205950	1" NPT	7-230PSI (0.5-16 bar)	7-60 PSI (0.5-4.0 bar)

Fix Ratio Pressure Reducing Valve

03801

Válvula Reductora de Presión FIX RATIO

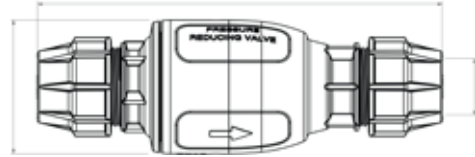

Product Code	pressure reducing ratio	Size d	D	L	W
0380120200A	2:1	2" IPS *	5.9	17.7	6.7
0380130200A	3:1	2" IPS*	5.9	17.7	6.2

* compression end for PE pipe

Angle Seat Valve (Seal NBR) Threaded Inlet & Outlet

03047

Válvula de asiento angular, (sello NBR) roscas macho

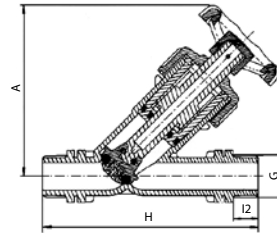

Product Code	Size G x G	H	I2	A	UB	UC	W
03047056	1/2" x 1/2"	5.28	0.63	4.45	5	120	0.30
03047073	3/4" x 3/4"	5.94	0.71	4.76	5	100	0.42
03047113	1" x 1"	6.69	0.79	5.51	—	70	0.62
03047189	1 1/4" x 1 1/4"	7.87	0.87	7.09	—	40	1.04
03047156	1 1/2" x 1 1/2"	8.86	0.87	8.15	—	24	1.62
03047223	2" x 2"	10.00	1.02	9.69	—	15	2.66

Angle Seat Valve (Seal FPM) Threaded Inlet & Outlet

03049

Válvula de asiento angular, (sello FPM) roscas macho

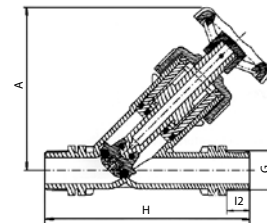

Product Code	Size G x G	H	I2	A	UB	UC	W
03049056	1/2" x 1/2"	5.28	0.63	4.45	5	120	0.30
03049073	3/4" x 3/4"	5.94	0.71	4.76	5	100	0.42
03049113	1" x 1"	6.69	0.79	5.51	—	70	0.62
03049189	1 1/4" x 1 1/4"	7.87	0.87	7.09	—	40	1.04
03049156	1 1/2" x 1 1/2"	8.86	0.87	8.15	—	24	1.62
03049223	2" x 2"	10.00	1.02	9.69	—	15	2.61

Quick Coupling Valve (Seal NBR)

03039

Válvula de acople rápido (juntas NBR)

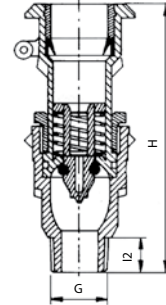

Product Code	Size G	H	I2	UB	UC	W
03039037	3/4"	5.75	0.67	5	130	0.32

Key for Quick Coupling Valve 3039

03139

Conexión de acople rápido

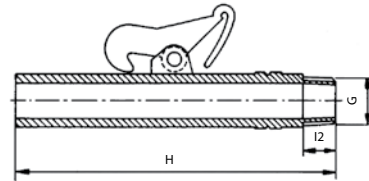

Product Code	Size G	H	I2	UB	UC	W
03139020	3/4"	6.81	0.71	5	250	0.15

Universal Slip Repair Coupler

17610

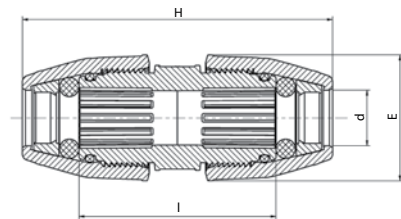

Product Code	Size d inch	IPS pipe size	CTS tube size	Size d mm	H	E	L	UB	UC	W
176100014018	0.55" - 0.71"	3/8	1/2	14-18	7.08	2.13	4.68	1		
176100019022	0.74" - 0.87"	1/2	3/4, 5/8	19-22	7.08	2.28	4.68	1	90	0.55
176100024028	0.94" - 1.1"	3/4	1	24-28	7.87	2.60	5.24	1	56	0.76
176100031035	1.22" - 1.37"	1	1.1/4	31-35	8.26	2.99	5.63	1	40	1.03
176100040043	1.57" - 1.69"	1.1/4	1.1/2	40-43	9.84	3.50	5.94	1	30	1.58
176100048051	1.89" - 2.00"	1.1/2	-	48-51	10.63	3.98	6.22	1	20	2.13
176100060064	2.36" - 2.52"	2	-	60-64	12.20	4.72	6.93	1	10	3.34

Plasson Wrench

07990

Llave Plasson



Product Code	Size	UB	UC	W
07990001	1/2" x 1 1/4"	—	250	65
07990005	1 1/2" x 2"	—	75	296
07990000	3" x 4"	—	40	840

Adaptor Coupling - IPS x mm

0701M

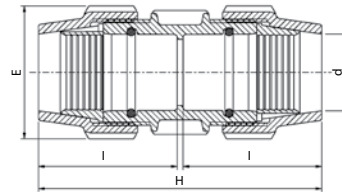

Product Code	Size d (inch) x d (mm)	E	H	I	UB	UC	W
0701M0020003							
0701M0020005	1/2" X 20	1.89	4.76	2.28	10	200	0.20
0701M0025007	3/4" X 25	2.13	4.92	2.36	10	100	0.26
0701M0032010	1" X 32	2.52	5.71	2.76	5	100	0.42
0701M0050015	1 1/2" X 50	3.78	7.91	3.86	—	45	1.05
0701M0063020	2" X 63	4.45	9.05	4.41	—	35	1.17

Split Ring for UPVC and PP pipes

07003Q



Product Code	Size d	E	H	UB	UC	W
07003Q0030P	3"	4.52	2.2	1	100	0.25
07003Q0040P	4"	5.47	1.6	1	85	0.26

O Ring Viton

07002MV



Product Code	Size d	UB	UC	W
07002MV020	2"	—	—	—
07002MV040	4"	—	—	—

Stainless steel adaptor disc for PVC

0797M

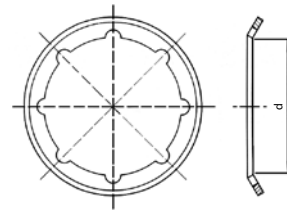

Product Code	Size d	UB	UC	W
797M020P	2"	—	—	—

Adaptor Coupling Transition from PE to PVC/PP Pipe

0701Q6

Enlace recto de transición para tubos de PE a PVC y PP



Product Code	Size	UB	UC	W
0701Q6063020	63 PE X 50(2") PVC	—	30	0.76
0701Q6110040	110 PE X 100(4") PVC	—	5	3.00

Chamfer Tool for PE Pipes

07960

Herramienta para biselar



Product Code	Size	UB	UC	W
079600063020	1/2"-2"	—	64	202